

The Sixth Biannual Reception Study Society Conference
Indiana University-Purdue University Fort Wayne
September 25-26, 2015

Thursday, Sept. 24

8:00 p.m. – 9:00 p.m. Informal Welcome at the Holiday Day Inn Mastodon Grill
no registration required, cash bar

Friday, Sept. 25

8:00 a.m. – 8:50 a.m. *Registration*
9:00 a.m. – 10:15 a.m. *Session One*
10:30 a.m. – 12:00 p.m. *Session Two*
12:00 p.m. – 1:00 p.m. *Lunch*
1:15 p.m. – 2:15 p.m. *Plenary Session A*
2:30 p.m. – 3:45 p.m. *Session Three*
4:00 p.m. – 5:30 p.m. *Session Four*
6:00 p.m. – 7:00 p.m. *RSS Reception*

Saturday, Sept. 26

8:00 a.m. – 9:00 a.m. *RSS Business Meeting*
9:15 a.m. – 10:15 a.m. *Plenary B*
10:30 a.m. – 12:00 p.m. *Session Five*
12:00 p.m. – 1:00 p.m. *Lunch, provided by RSS*
1:15 p.m. – 2:30 p.m. *Session Six*
2:45 p.m. – 3:45 p.m. *Plenary C*
4:00 p.m. – 5:30 p.m. *Session Seven*
7:00 p.m. – 9:00 p.m. *Banquet*

The Sixth Biannual Reception Study Society Conference has received generous support from the Indiana University-Purdue University Chapman Distinguished Professor of English and the Office of the Vice-Chancellor of Academic Affairs.

FRIDAY, SEPT. 25

8:00 a.m. – 8:50 a.m.

Registration and Check-in

Walb Union First Floor Lobby

9:00 a.m. – 10:15 a.m.

Session One

Session 1-A: Identities and Reading

Moderator: M. L. Stapleton

Room: Walb Union 224-226

“A Feminist Reception Study on George Gissing’s Male Gaze in *The Odd Women*”
Wendy Sun, Loyola Marymount University

“Richard Wright between Two Fronts”
Kinohi Nishikawa, Princeton University

“Toward a Queer Reception Theory: The Case of *Nightwood*”
Laura Wallace, The University of Texas at Austin

Session 1-B: Graphic Reading

Moderator: Steven Carr

Room: Walb Union G21

“Making Reading Popular: Cold War Literacy and *Classics Illustrated*”
Kristin Matthews, Brigham Young University

“Going *Mad*: The Cultural Economics of *Mad* Comic Books”
Matt Yockey, University of Toledo

“‘This is the Closest Thing You’re Going to Get to Holding an Idea, This is the Closest Thing an Idea is Gonna Become to Being Physical’: Affordances of Comics Print and Digital Reading”
Lucia Cedeira Serantes, Queens College (CUNY)

10:30 a.m. – 12:00 p.m.

Session Two

Session 2-A: Publication Histories

Moderator: James Machor

Room: Walb Union 224-226

“Pseudotranslation and Its Reception: The Case of Walter Scott”
Tom Toremans, KU Leuven

“The Medievalism of the Future: The Kelmscott *Chaucer* and J. M. Dent’s *Le Morte Darthur*”
Jane Glaubman, Cornell University

“From BBC Broadcasts to Church of Scotland Monthly: A Correction to the Bibliography of
C. S. Lewis’s *Mere Christianity*”
Stephanie Derrick, independent scholar

Session 2-B: Fans

Moderator: Ika Willis

Room: Walb Union G21

“We are the Districts: Fannish Resistance to *The Hunger Games* Marketing Campaigns”
Hannah Mueller, Cornell University

“Many Individual Narrators and One Attentive Audience: Online Discussions of *A Song of Ice and Fire*
and *Game of Thrones*”
Ildiko Olasz, Northwest Missouri State University

“‘Racebent Hermione’, Color-blind Casting, and Emancipatory Fandom”
Seth Soulstein, Cornell University

“I Spy Women Reading”
Yung-Hsing Wu, University of Louisiana at Lafayette

12:00 p.m. – 1:00 p.m.

Lunch (see registration packet for options on lunch venues on/near campus)

RSS Executive Session

Walb Union 114

1:15 p.m. – 2:15 p.m.

Plenary A

Walb Union International Ballroom North

“When Literature Mattered”

George B. Hutchinson, Newton C. Farr Professor of American Culture, Cornell University

2:30 p.m. – 3:45 p.m.

Session Three

Session 3-A: Multicultural Reception and Author Reputation

Moderator: *Matthew James Vechinski*

Room: *Walb Union G21*

“There is no other book more important to me than this one’: Alice Walker’s *Zora*”
Jennifer Freeman Marshall, Purdue University

“Toni Morrison Contestations: A Multicultural, Global Perspective on a Writer and Identity”
Philathia Bolton, University of Akron

“Multicultural Education and the Reception of *The House on Mango Street*”
Allison Layfield, Purdue University

Session 3-B: After Images: Contemporary TV Viewing Practices

Moderator: *Susan McLeland*

Room: *Walb Union 224-226*

“Six Seasons and a Movie’: Traveling the Rabbit Hole of Community’s Communities Across Multiple”
Media Platforms”
Sharon Marie Ross, Columbia College Chicago

“Trash Talk and Virtual Protests: The Musical Genre’s Personal and Political Edge in the Age of the Internet”
Kelly Kessler, DePaul University

“The Pleasures of Synopsis: Recaps, Analyses, and the On-Line Watercooler”
Susan McLeland, independent scholar

4:00 p.m. – 5:30 p.m.

Session Four

Session 4-A: Reading African-American Fiction: From Charles Chesnutt to Toni Morrison

Moderator: *James Machor*

Room: *Walb Union G21*

“Slight Connections: Navigating Race and Regionalism in the Reception of Charles Chesnutt”
Kelsey Squire, Ohio Dominican University

“Affecting Identity in the Black Chicago Renaissance: Margaret Walker’s *For My People*”
Mary Unger, Ripon College

“Toni Morrison’s *A Mercy*: The Critique of Patriarchy and History’s Lost Opportunities”
Philip Goldstein, University of Delaware

Session 4-B: Extreme Reading

Moderator: Janet Staiger

Room: Walb Union 224-226

“Backwoods Slasher Remakes and the Politics of White American Masculinity”

Emily Satterwhite, Virginia Tech

“Literary IRONMAN: Book List Books and Nonacademic Reading Challenges”

Cheryl A. Read, Duquesne University

“A Year of Extreme Reading Adventures Saved My Life: The Construction of Reading in Twenty-First Century Bibliomemoirs”

Ika Willis, University of Wollongong, Australia

Session 4-C: Reading Directions

Moderator: John Young

Room: Walb Union 114

“*Osteographia* and *Animadversions*: Talking Down the Bones”

Jennifer Burek Pierce, University of Iowa

“American Readers and Felicia Hemans’ ‘Landing of the Pilgrim Fathers’”

Bianca Falbo, Lafayette College

“Literacy, Anti-Literacy, and Illiteracy in *Uncle Tom’s Cabin*”

Faye Halpern, University of Calgary

“On Annotating Ander Monson’s *Letter to a Future Lover: Marginalia, Errata, Secrets, Inscriptions, and Other Ephemera Found in Libraries*”

Daniel Morris, Purdue University

6:00 p.m. – 7:00 p.m.

RSS Reception

IPFW Alumni Center, Grand Lobby

Hors d’oeuvre and bar provided by RSS

SATURDAY, SEPT. 26

8:00 a.m. – 9:00 a.m.

RSS Members Meeting

Room: Rhinehart 235

9:15 a.m. – 10:15 a.m.

Plenary B

Walb Union International Ballroom North

“That Bronte Girl: Intermedial Fantasy and the Adolescent Paracosm”

Jeffrey Sconce, Associate Professor of Radio/TV/Film, Northwestern University

10:30 a.m. – 12:00 p.m.

Session Five

Session 5-A: Mark Twain’s Audiences: Reception Histories and Reconstructed Reading Communities

Moderator: Amy Blair

Room: Walb Union G21

“Reconstructing the Reading Community of the *Century*: The Pre-Published Chapters of *Huckleberry Finn*”

Barbara Hochman, Ben Gurion University of the Negev

“Detective Fiction: From *Pudd’nHead Wilson* to *The Double-Barrelled Detective Story*”

Philip Goldstein, University of Delaware

Interpretation, Genre, and the Public and Private Responses to *The Prince and the Pauper* in Postbellum America and Britain

James L. Machor, Kansas State University

Session 5-B: Media Potpourri

Moderator: Walter Metz

Room: Walb Union 224-226

“On Reading and Rumor: Kenneth Goldsmith’s ‘The Body of Michael Brown’”

Daniel Morris, Purdue University

“Reinvigorating Reality and Fantasy: *The Quest* and the Response to Reality Television”

Edward Royston, Texas Woman’s University

"The Bibliographic Trace in Spike Jonze's Film *Her*"
Gillian Silverman, University of Colorado Denver

Session 5-C: Theory

Moderator: Tom Toremans

Room: Walb Union 114

"Human and Computer Readers: A Reception Study"
Patrick Donovan, University of Louisiana at Lafayette

"Surface Reading and Theory of Mind"
Molly Travis, Tulane University

"Three-Way Dialogues: Mediations of the Text-Reader Encounter"
Ika Willis, University of Wollongong, Australia

12:00 p.m. – 1:00 p.m.

Walb Union International Ballroom South

LUNCH, provided by RSS, rsvp required

1:15 p.m. – 2:30 p.m.

Session Six

Session 6-A: Medieval and Renaissance Receptions

Moderator: M. L. Stapleton

Room: Walb Union G21

"The Reception of Hebrew in Anglo-Saxon England"
Damian Fleming, Indiana University-Purdue University Fort Wayne

"Thomas Heywood and the *Ars Amatoria*"
M.L. Stapleton, Indiana University-Purdue University Fort Wayne

"Reception of the Church Fathers in the Twelfth Century: The Case of Anselm of Laon"
Suzanne M. LaVere, Indiana University-Purdue University Fort Wayne

Session 6-B: Blurred Biographies: Fictions and/or/as Realities

Moderator: Walter Metz

Room: Walb Union 224-226

"'I Am Not Certain C.C. Is Not a Jew': Reception, Perception, and the Identity Politics of Charlie Chaplin's Jewishness During the Making of *The Great Dictator*"
Steven Alan Carr, Indiana University-Purdue University Fort Wayne

"Mailer and *Maidstone*: When *Cinéma Vérité* Fiction Becomes Real"
Janet Staiger, The University of Texas at Austin

"Securing the Historical Tales of Real Scientists: Film Production as Reading"
Walter Metz, Southern Illinois University

Session 6-C: From Periodicals to Books: Publication Contexts and Reception

Moderator: Matthew James Vechinski

Room: Walb Union 114

"The column and the closet: Richard Le Gallienne and Decadence in the *Illustrated London News*"
Patrick Collier, Ball State University

"*Cane*'s Original Readers: Jean Toomer and 1920s Magazines"
John K. Young, Marshall University

"The Short Story Writer Keeping Company with Polemical Magazines: The Reception of Mary McCarthy's Early Autobiographical Fiction"
Matthew James Vechinski, Virginia Commonwealth University

2:45 p.m. – 3:45 p.m.

Plenary C

Walb Union International Ballroom North

"How Historical is Reading? What Literary Studies Can Learn from Neuroscience (and Vice Versa)"

Paul Armstrong, Professor of English, Brown University

4:00 p.m. – 5:30 p.m.

Session Seven

Session 7-A: Students Reading

Moderator: Damian Fleming

Room: Walb Union G21

"Creating Active Readers? Students Reading *Oryx and Crake*"
Karma Waltonen, University of California, Davis

"Reading *Lolita* at St. Kate's"
Cecilia Konchar Farr, St. Catherine University

“A Case for Folklore As Reception: Teaching Shirley Jackson’s *We Have Always Lived in the Castle*”
Shelley Ingram, University of Louisiana at Lafayette

Session 7-B: Women Authors, Women Readers

Moderator: Gillian Silverman

Room: Walb Union 224-226

“Eileen Chang’s Reception History: 1943-2013”
Sijia Yao, Purdue University

“The Celebrity Writer: A Case Study on Margaret Atwood”
Charlotte Templin, University of Indianapolis

“Daughter, Mother, Reader: Interpretation and Intimacy in the Sylvia Plath Archive”
Janet Badia, Indiana University-Purdue University Fort Wayne

“‘Tasting and Testing Books’: *Good Housekeeping* and the Modern Middlebrow Reader”
Amy Blair, Marquette University

7:00 p.m. – 9:00 p.m.

RSS Banquet (advanced purchase required)

IPFW Alumni Center, Meeting Rooms

Essential Conference Information

Wireless on Campus:

You can access the wireless network in Walb Union with the following information:

SSID Network: WalbConf1

Password: Mastodons (capital M and plural)

Campus Shuttle Schedule for Friday and Saturday:

7:45 AM: Departure from entrance to Holiday Inn

7:55 AM: Departure from entrance to Holiday Inn

8:05 AM: Departure from entrance to Holiday Inn

8:15 AM: Departure from entrance to Holiday Inn

8:25 AM: Departure from entrance to Holiday Inn

8:35 AM: Departure from entrance to Holiday Inn

8:45 AM: Departure from entrance to Holiday Inn

8:55 AM: Departure from entrance to Holiday Inn

5:25 PM: Departure from Walb Circle Drive to Holiday Inn and IPFW Alumni Center

5:35 PM: Departure from Walb Circle Drive to Holiday Inn and IPFW Alumni Center

5:45 PM: Departure from Walb Circle Drive to Holiday Inn and IPFW Alumni Center

5:55 PM: Departure from Walb Circle Drive to Holiday Inn and IPFW Alumni Center

6:05 PM: Departure from Walb Circle Drive to Holiday Inn and IPFW Alumni Center

6:15 PM: Departure from Walb Circle Drive to Holiday Inn and IPFW Alumni Center

Walb Circle Drive is immediately outside the southeast entrance of Walb Union, under the Walb Skybridge. Please look for the white van with the RSS sign on its doors. Should you need shuttle transportation during other times, please call 260-418-6616 to arrange for pick up. We will do our best to accommodate you.

Food and Coffee:

For lunch on Friday, your most efficient options are the cafeteria in the basement of Walb Union or the sandwich shop in the basement of Kettler Hall (about a 5 minutes walk south of Walb Union). Both have a range of options, including vegetarian ones. Please see the information in your registration packet for additional information about restaurants near campus. All food options on campus are closed on Saturday.

On Friday, the Java Spot on the first floor of Walb Union (near the bookstore) will be open from 8:00-3:00 PM for your caffeine needs. On Saturday morning and afternoon, we will have coffee and tea available in Walb Union 222.

Walb Union Map

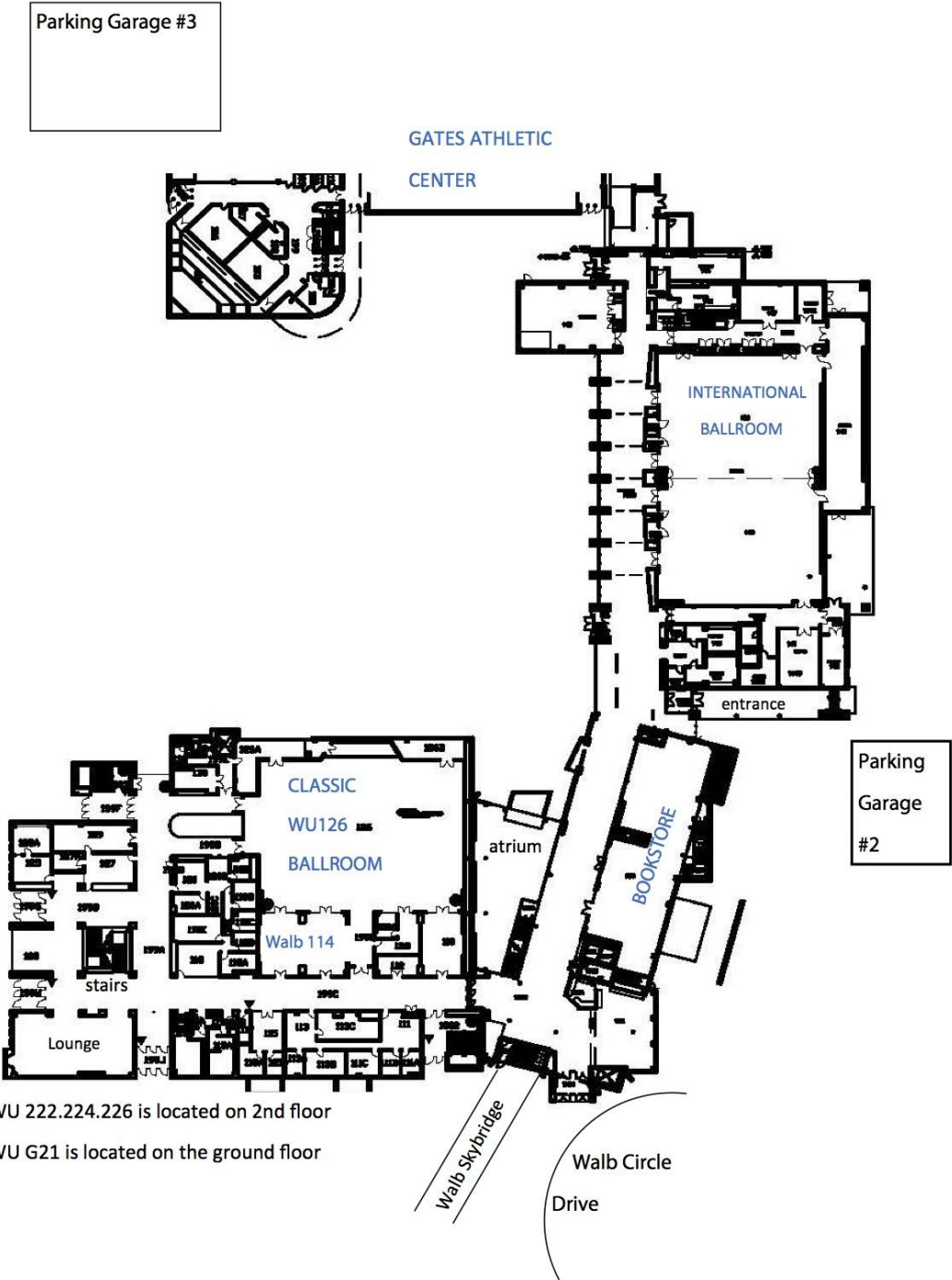

WU 222.224.226 is located on 2nd floor
WU G21 is located on the ground floor

Notes